

# INSTRUCTIONS FOR THE DISPLAY MOUNTING CUPS

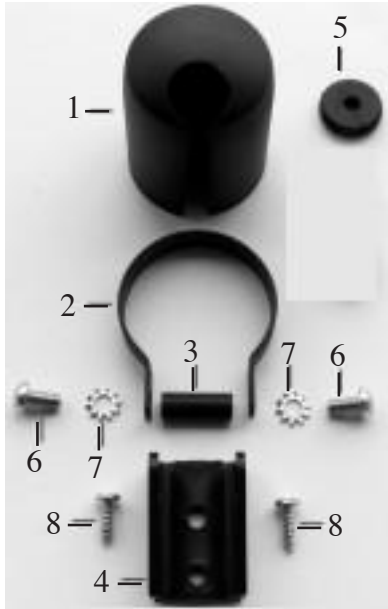

## Contents



1. Gauge cup
2. Strap
3. Spacer
4. Base
5. Grommet
6. 1/4-20 screws (qty 2)
7. Star washers (qty 2)
8. #10x5/8" screws (qty 2)

**Assembly:** It is easiest to pre-assemble the cup outside of the vehicle prior to mounting to the vehicle. You will first want to loosely attach the strap to the base, using the spacer and the two 1/4-20 screws and star washers (reference picture 2).



Picture #2



Mount the strap assembly (that is still loosely connected to the base) to your mounting surface. You may use the included #10x5/8" screws for this.

Now that the strap assembly is mounted to the vehicle, install the grommet into the cup (if being used) and slide the cup into place. We recommend leaving enough wire slack to be able to hook up your display, then slide the display into place. Once you are satisfied with the angle and mounting of the display, tighten the two 1/4"-20 screws to lock the gauge and angle in place.

**C.I.E.** CHAMPION  
INDUSTRIAL  
EQUIPMENT

2855 Marleau Avenue, Suite A, Cornwall, Ontario K6H 7B6  
Tel: 613 938-2900 Fax: 613 938-8219  
[www.cie-eic.com](http://www.cie-eic.com)